

Technical Data Sheet



Product name:
Skatepark Walk-Box - h 25cm

Date create:
2015-04-28

Code:
181220

Destination:
Skate Park

Scale:
1:25

Construction materials:
Concrete of class C 35/45, hot dip galvanized steel

Weight:
940 kilos

Notes:

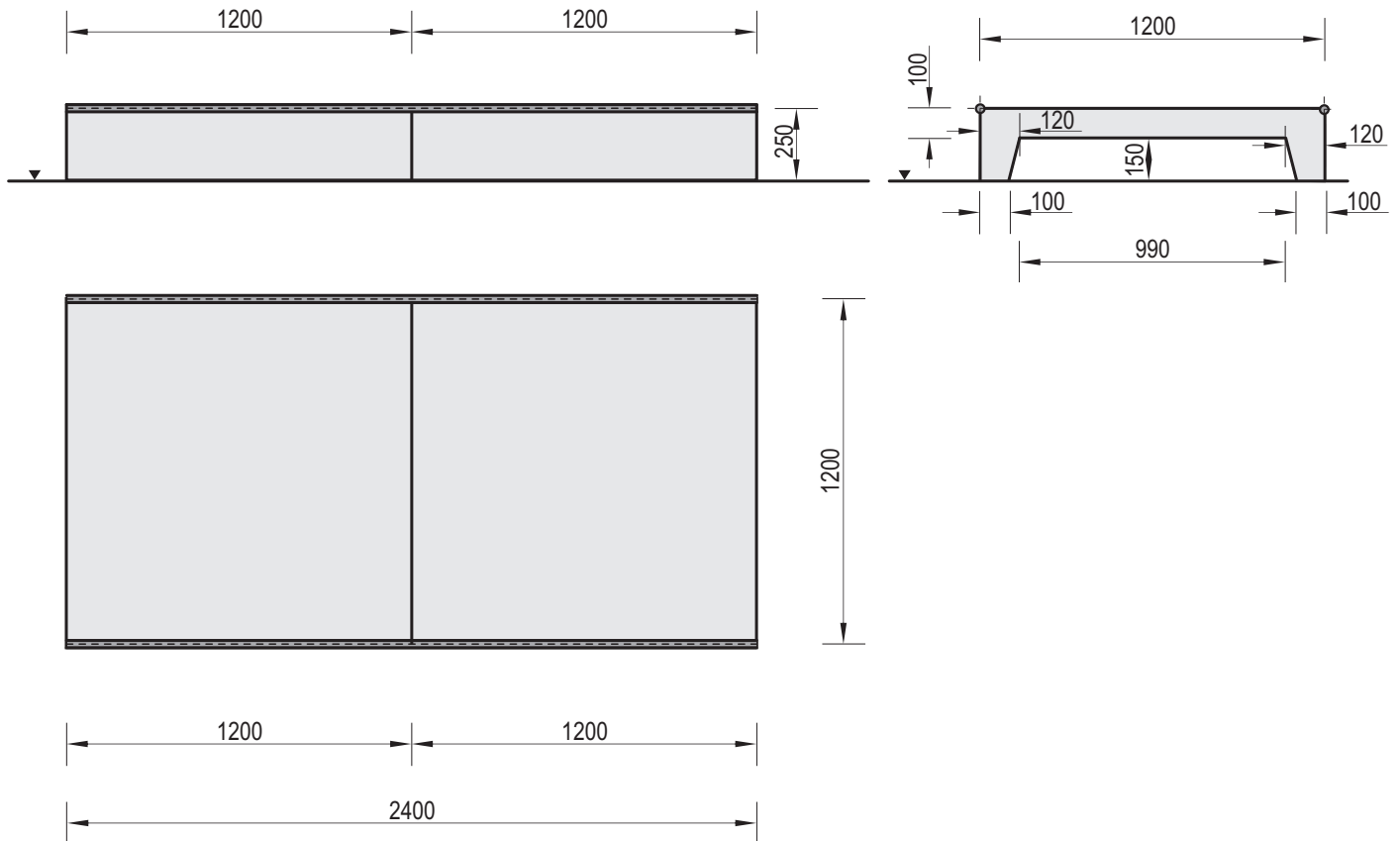

Technical description:

- Construction made of concrete class C 35/45 and hot dip galvanized steel
- Side rail made of steel pipe $\varnothing 35 \times 2$ mm,
- Walk Box can be mounted as a standalone element, or as a part of bigger skate park set,
- Concrete elements are protected against water conditions effect by impregnation and painted with acrylic paint PILBET

WARNING ! Children are allowed to use the item only under supervision of adults.