



It shall apply from: 13-01-2016 r.

THE ASSEMBLY INSTRUCTION OF:
Fun-box 13
PRODUCT CODE: 109398



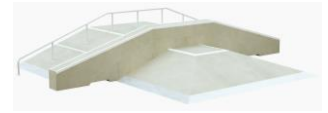
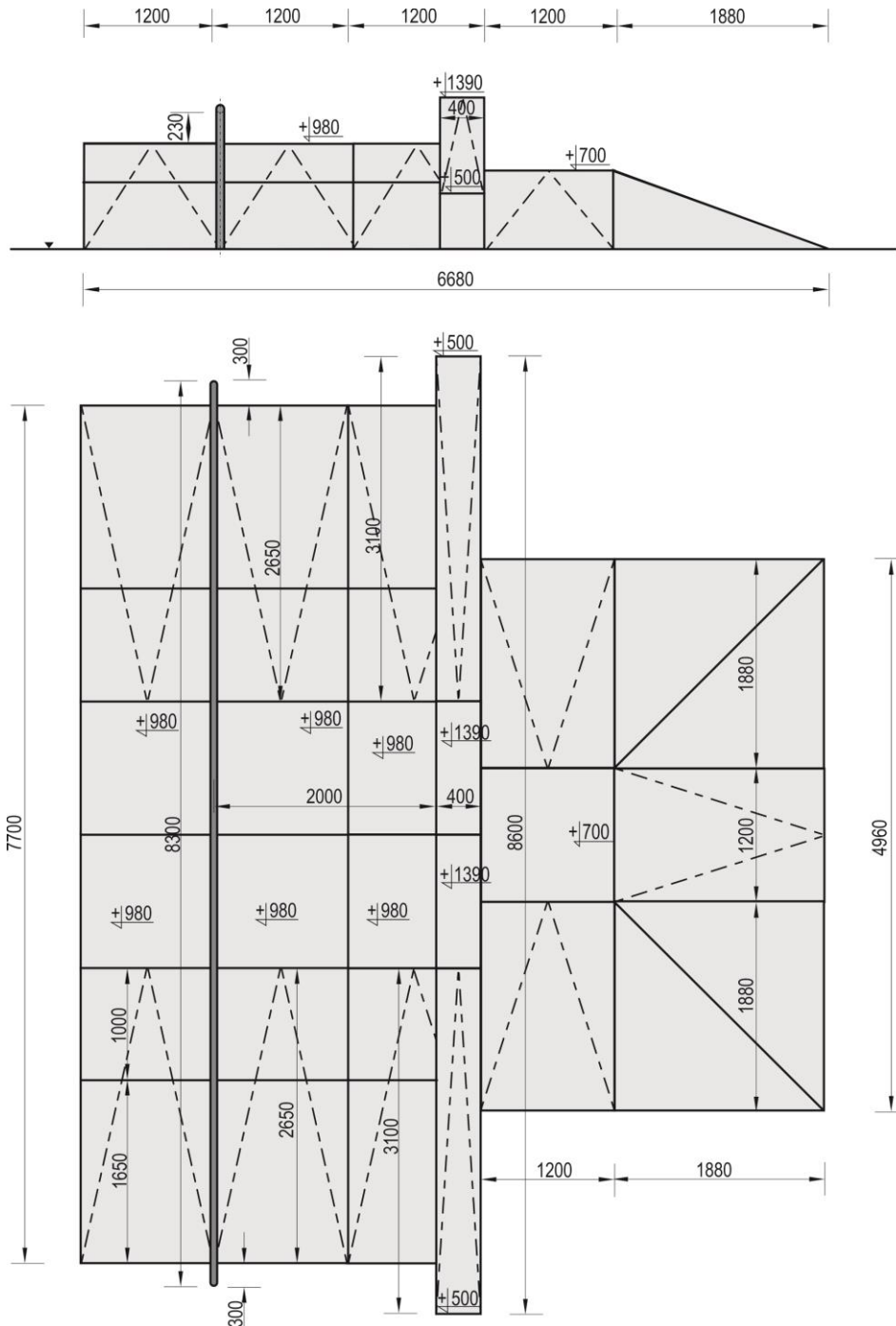

TABLE OF CONTENTS

INTRODUCTION	2
STAGE 1 – Preparatory work/ safety zone	3
STAGE 2 – Assembly of the construction	3
1. List of components	3
2. Assembly scheme	4

INTRODUCTION

- Overall dimensions: 6,88 x 8,60 x 1,39m



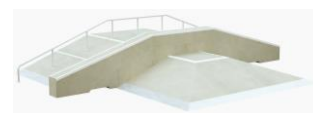

STAGE 1 – Preparatory work/ safety zone

- Secure the assembly site to keep others at a distance
- Set the construction in a designated place having regard to required impact area.

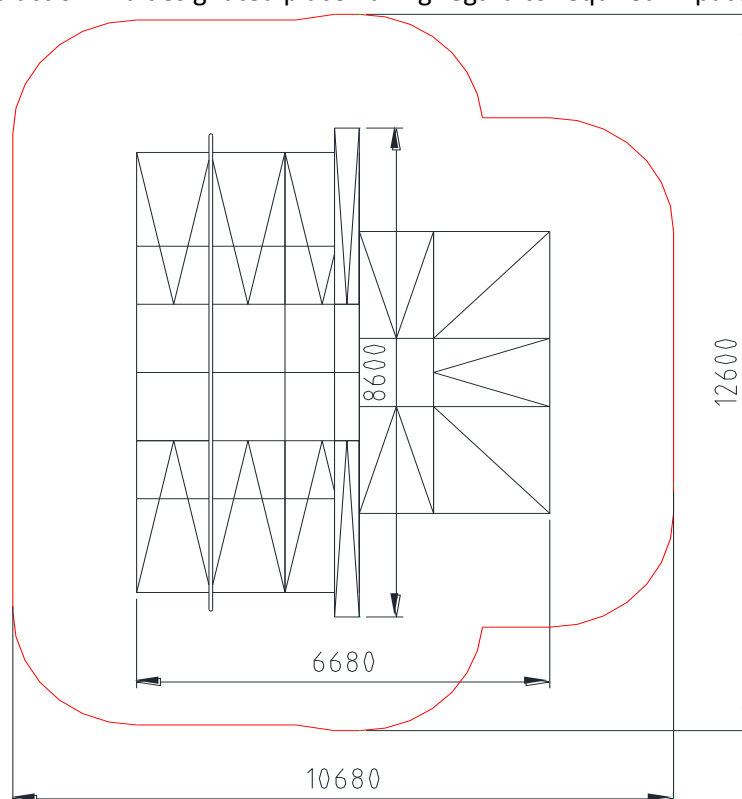

WARNING!

Installation shall be performed in accordance with safety & health standards

STAGE 2 – Assembly of the construction

1. List of components

NO.	NA,E PF COMPONENT	DIMENSIONS	QTY.	NORM
1	Box 980 3S	1200x1200x980	4	160098.03S
2	Box 980 2S	1200x1200x980	2	160098.02S
3	Box 700 3S	1200x1200x700	1	160070.03S
4	Bank 700		3	151270.00Z
5	Bank 600		6	151260.00Z
6	Additional component of Bank 980		6	151298.0DB
7	Corner		2	155270.100
8	Grind box straight	400x400x1200	2	161070.100
9	Grind box slanted		2	
10	Steel toe plate for Bank	250x1200	9	SN.250.000
11	Left steel toe plate for Corner	1890x250x4	2	SNC.250L.000
12	Right steel toe plate for Corner	1890x250x4	2	SNC.250P.000
13	Steel plate for top of the corner		2	SP.CR.001
14	Steel sheet plate for Bank-Box	139x1200x5	1	SP.Ł.101 LR
15, 16	Steel sheet plate Bank-Box	139x1200x5	8	SP.Ł.101
17	Connecting steel sheet	100x1200x5	3	SP.Ł.100
18	Grind box straight connector	320x100x5	1	SP.GB.200
19	Grind box slanted connector	320x140x5	2	SP.GB.300

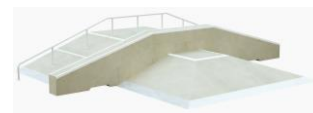

20	Olly Box connector	153x50x5	12	SP.Ł.104
21	Bank 980 connector	142x1200x5	6	SP.Ł.102
22	Rail 980 Bank-2xBox-Bank		1	SP.R98.002
23	Side rail for Bank 980		1	SP.BK.003L
24	Side rail for Bank 980		1	SP.BK.003R
25	Side rail for Box		1	SP.BX.004 L
26	Side rail for Box		1	SP.BX.004 R
27	Countersunk screw - torx	TX45 - M8x16	90	ISO 14581
28	Countersunk screw	M10 x 20	242	DIN 7991
29	Hexagon head screw	M10 x 25	66	DIN 933
30	Washer	Ø30xØ10,5x2,5 (M10)	66	DIN 9021
31	Expansion bolt	Ø10x80	30	

2. Assembly scheme

- Screw the steel toe plates (point 10) to the Banks (point 4 and 5) with items of point 27, 29 and 30. Screw the steel toe plates (point 11 and 12) to the Corners (point 7) with items of point 27.

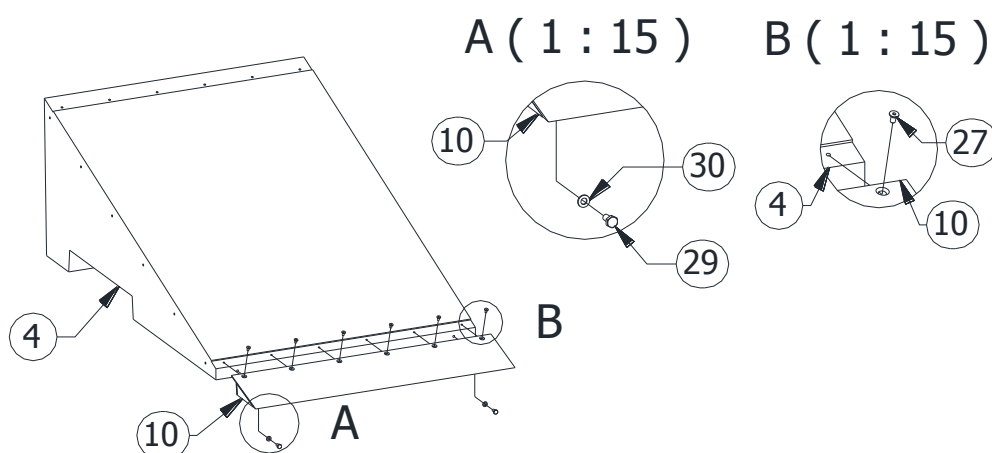

- Place the concrete elements according to the illustration below:

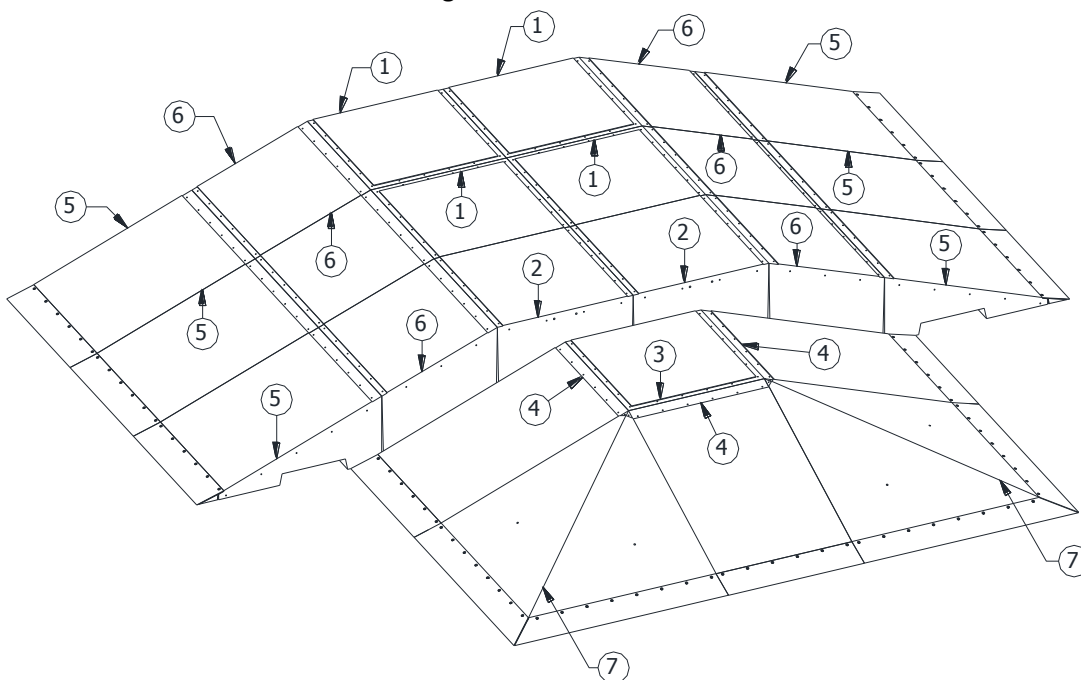

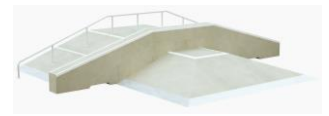

- Connect the concrete elements by screwing connecting sheets (point 14, 15, 16, 17, 21) with items of point 28. Screw the top plate (point 13) to the Corners with items of point 28.

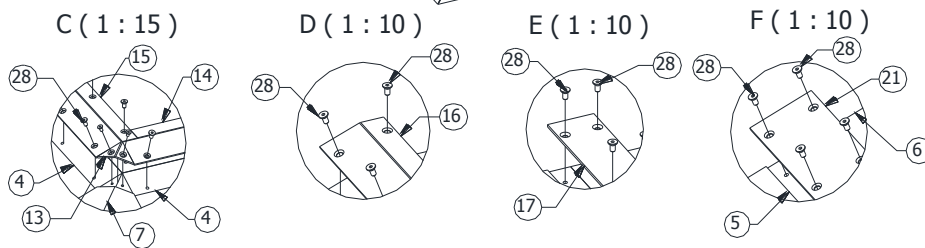
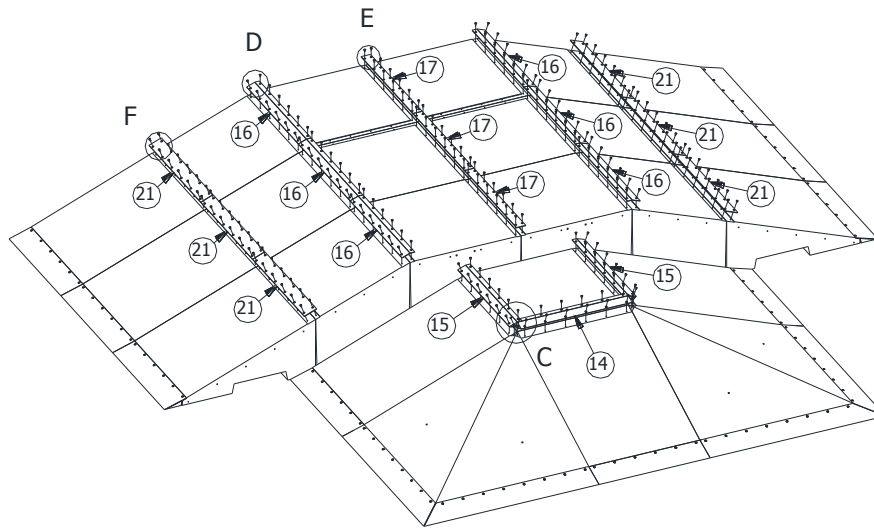

- Set the Grind Boxes (point 8 and 9) and screw the together with items of points 18, 19, 28. Additionally screw the Grind Boxes to the device by using items of points 20, 29 and 30.

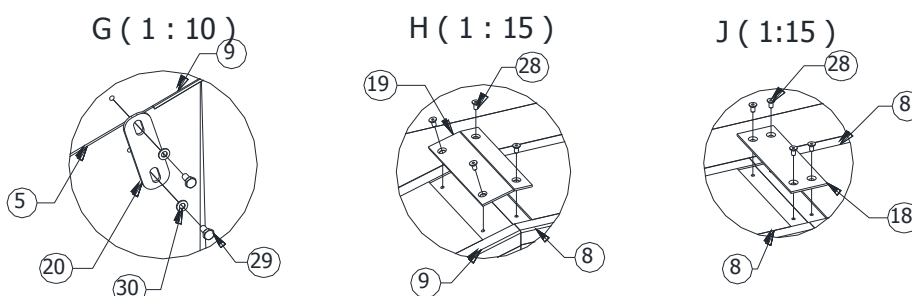
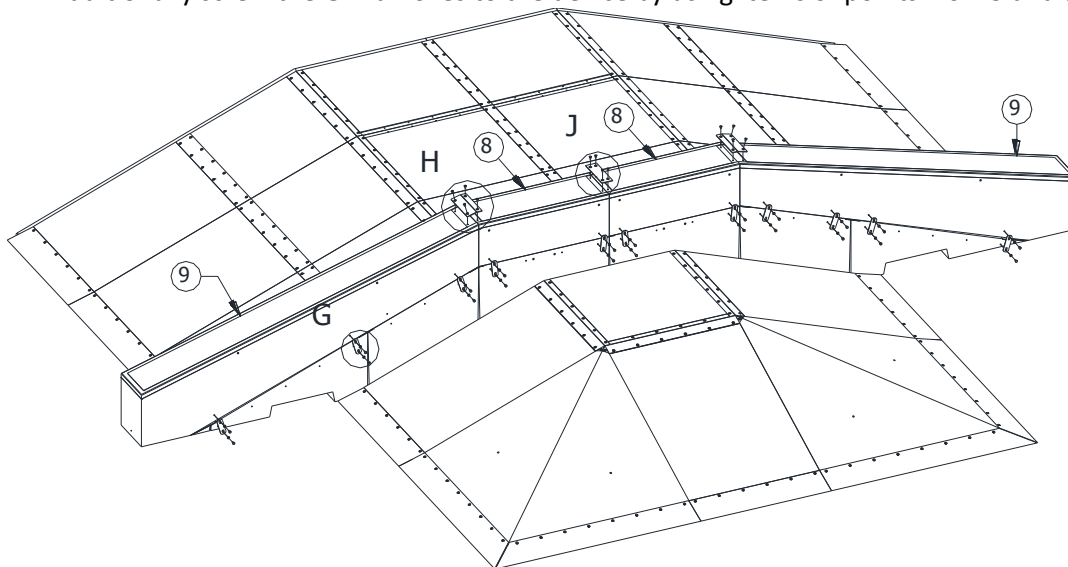

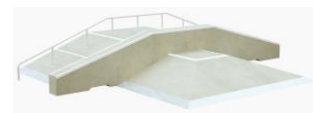

- Screw the side rails (point 23-26) to the device by using items of points 29 and 30.
- Screw the whole Rail (point 22) to the construction with items of point 28. The ends of the Rail shall be concreted with concrete of class C25/30.

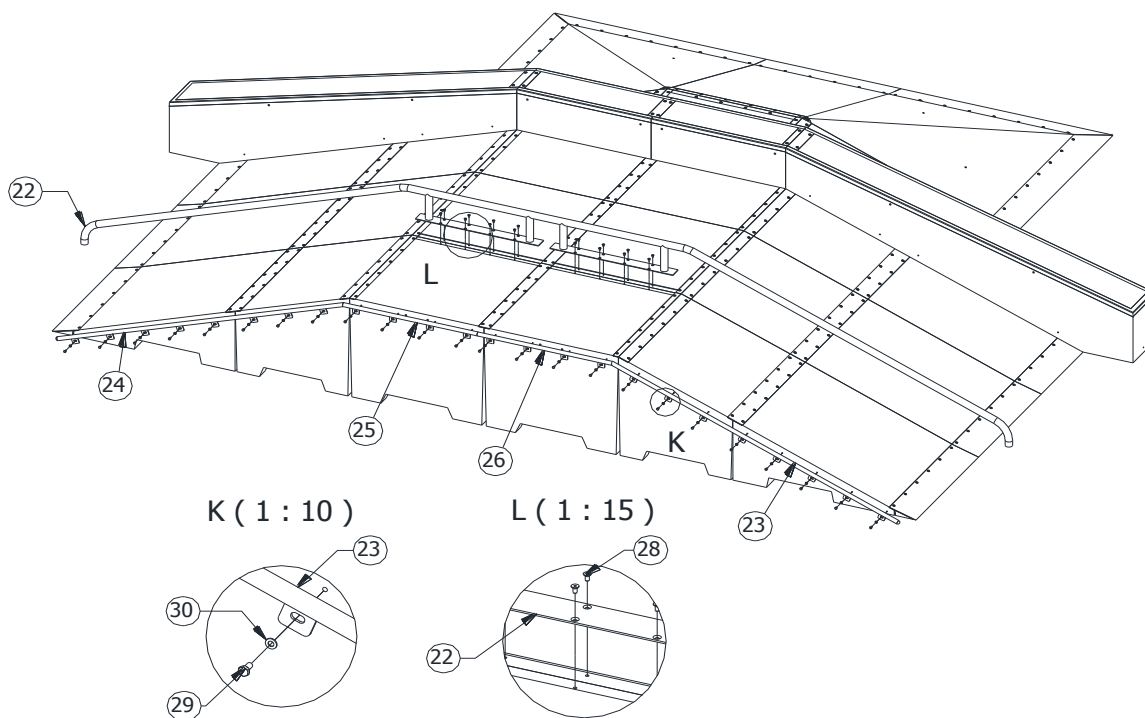

- Fix the steel toe plates to the ground by using bolts of point 31.
- Remove the slacks in joints
- Put the statutory plate