

It shall apply from: **05-09-2018 r.**

ASSEMBLY INSTRUCTION
OF **SKY SURFER**
CATALOGUE NUMBER: **23500**

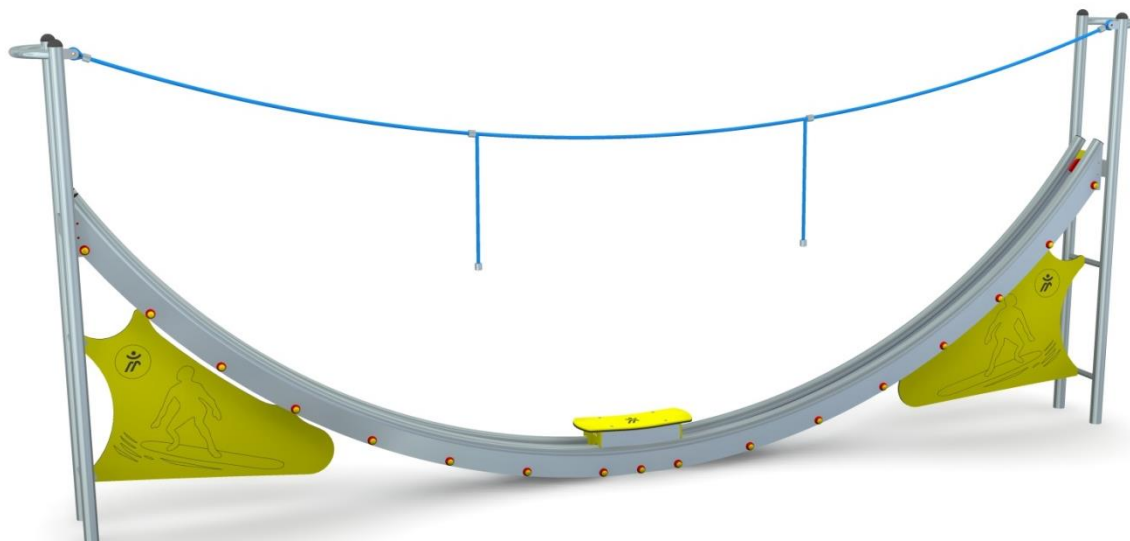

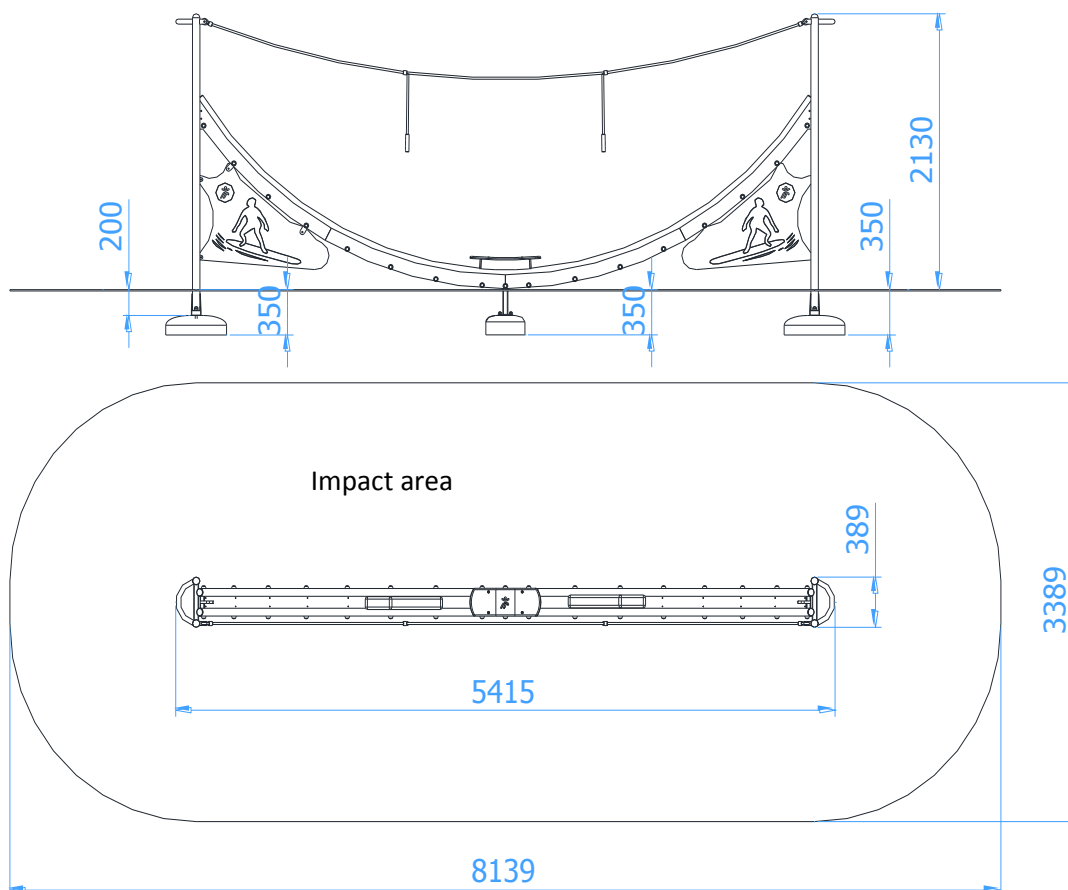

TABLE OF CONTENTS

INTRODUCTION	2
STAGE 1 – preparatory work	3
STAGE 2 – assembly of the construction	3
1. List of components	3
2. Assembly scheme	4

INTRODUCTION

- Maximum free fall height: 1,49m
- Depth of foundation: 0,35m
- Impact area: 8,14 x 3,39m





STAGE 1 – preparatory work

- Secure the assembly site to keep others at a distance
- Set the construction in the selected location while maintaining required impact area
- Mark approximately points of contact between stanchions and the ground.

Foundations positions:

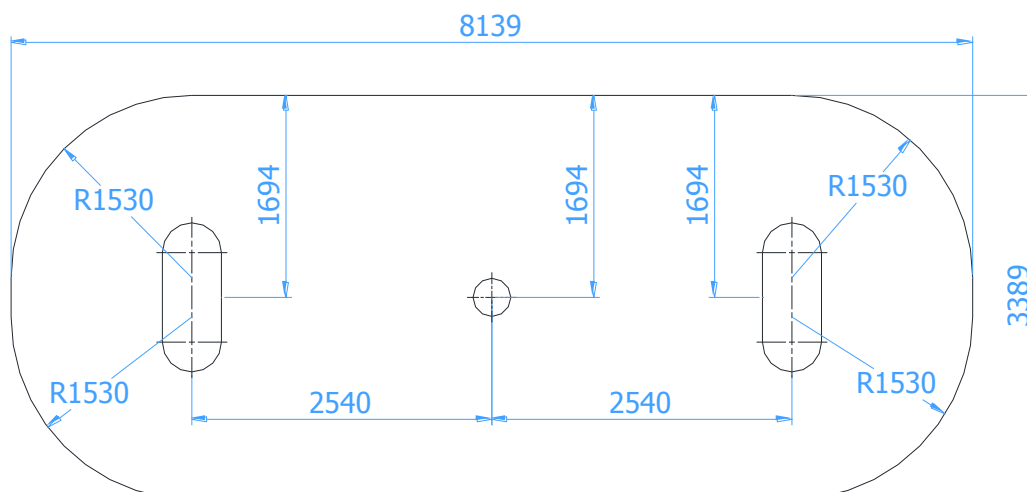

WARNING !

All installation activities shall be performed in accordance with health and safety standards
A foundation setup tolerance is ± 50 mm.

STAGE 2 – assembly of the construction

1. List of components

No	Name of component	Dimension	Qty.	Norm
1	Sky surfer		1	
2	Foundation	OW-1240	2	
3	Foundation	O-320-4D	1	
4	Hexagon head screw	M16 x 70	4	DIN 933
5	Hexagon head screw	M10 x 25	4	DIN 933
6	Washer	M16	4	DIN 125
7	Washer	M10	4	DIN 125
8	Screw cover	M16	4	
9	Screw cover	M10	4	



2. Assembly scheme

- Determine foundation setup
- Turf (if any) shall be removed and set aside
- Excavate holes for foundations with a appropriate depth
- Put the foundations into the holes
- Fix the device to the foundations

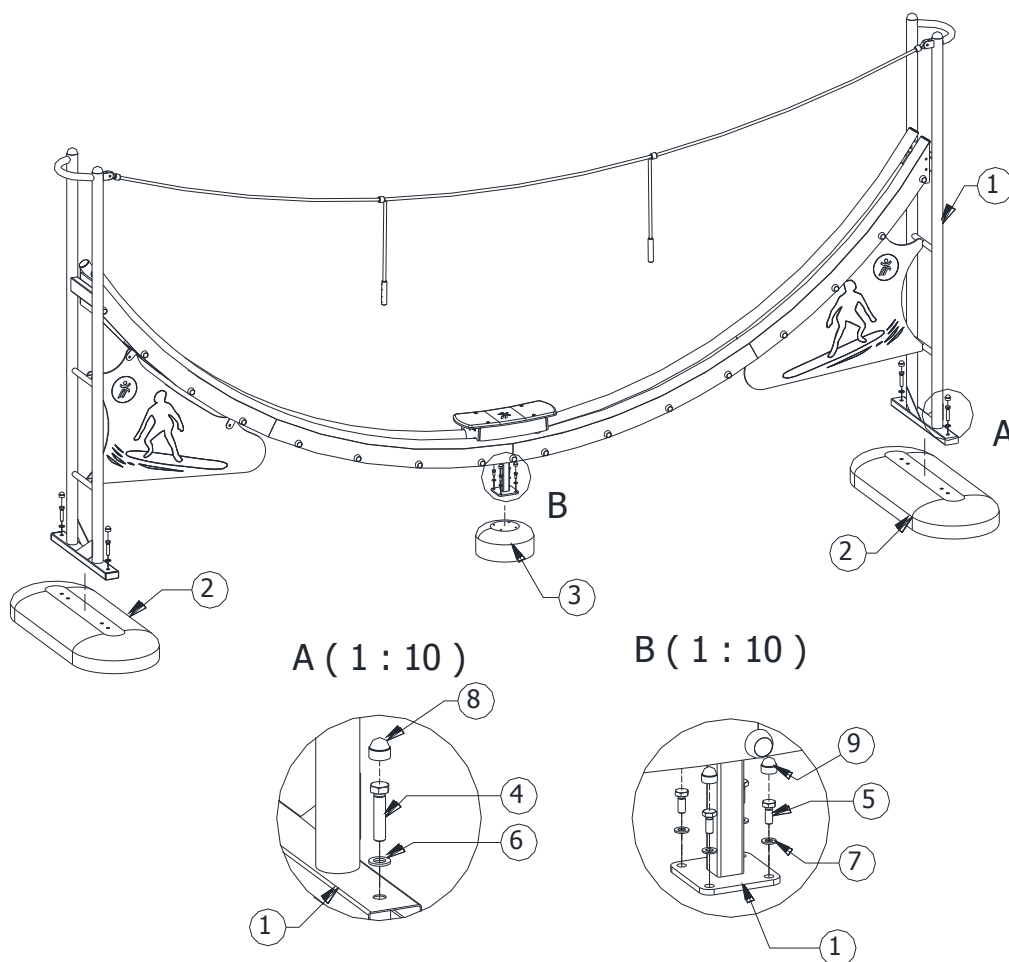

- Level the construction and set its vertical alignment. Check if the basic level mark coincides with level of the ground.
- Remove the slacks in joints
- Fill the holes with soil, compact it and level it with turf (if any) to the level of the ground
- Put the statutory plate